

Chronoscope CMS



Chronoscope CMS, the flexible measuring system for the watchmaking industry!

The CMS permits the simultaneous measurement of mechanical or quartz watches with or without a strap and has been specially designed for use on an industrial scale based on a flexible concept. Its modular design makes it possible to customise the measuring system to suit the client's requirements precisely.

Up to 25 measurement channels in a single system

Systems with up to 25 measurement channels can be put together flexibly. Measured values are analysed and displayed with a PC that is connected to the measuring system via a USB port. WiCoTRACE software makes efficient test parameter and result management easier.

Standard microphones and customer-specific sensors



If required, customer-specific sensors can be manufactured. This is because, thanks to the innovation of Witschi's engineers, a solution can be found for every problem, for example sensors for use in special environmental conditions or button microphones for special carriers and pallet systems.

Chronoscope CMS

Chronoscope CMS

- Simultaneous measurement of mechanical and quartz watches with up to 25 channels
- Measurement electronics for installation in standard 19" racks and with a USB port for analysis of measurements on a PC
- Large number of standard microphones and customer-specific sensors
- Inductive sensors for the measurement of quartz watches
- Suitable for measurements in a climatic chamber
- Analogue preamplifiers and amplifiers with low-impedance technology for trouble-free measurement
- Selective analogue filters: immune to common environmental noise
- CAG automatic amplifier adjustment: good reception of weak signals
- Calibration interface on front of housing for easy standardised calibration (Witschi reference time base)

Housing versions available

	 3 HE plug-in for 19" rack systems	 2 HE plug-in for 19" rack systems	 Table-top housing
Measurement channels	20 or 25	2, 4, 5 or 10	2, 4, 5 or 10
Dimensions (W x H x D)	482 x 133 x 289 mm	482 x 88 x 480 mm	236 x 88 x 331 mm
LEDs for Good/Bad display in corresponding number of measurement channels	•	•	
Alphanumeric display and function keys for retrieving and processing system settings	•	•	•
Interface for calibration of the measuring system	•	•	•
USB port	•	•	•
12C bus for connecting external sensors (e.g. temperature sensor)	•	•	•

Microphone options (examples)



Measurement of mechanical watches in pallet systems with sensing on the watch glass or hemispherical joint.

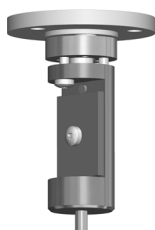

For integration into industrial applications where space is limited.



Sensing on the watch glass or hemispherical joint through small aperture in closed watch boxes.

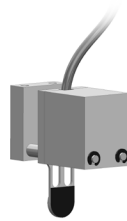

Extra-slim button microphone for sensing beat noises on the watch winder knob.



Use in strong magnetic fields of up to 15,000 Gauss (1.5 Tesla)



Button microphone for sensing beat noises on the winder shaft of the watch.